

# 1998 Ford EXPLORER

Submodel: | Engine Type: V6 | Liters: 4.0  
Fuel Delivery: FI | Fuel: GAS

SECTION 303-04A: Fuel Charging and Controls — 4.0L Push Rod  
DESCRIPTION AND OPERATION

1998 Explorer/Mountaineer Workshop Manual  
[Procedure revision date: 02/16/2000](#)

## Fuel Charging and Controls

The fuel charging and controls system consists of the:

- throttle body (9E926).
- fuel injectors.
- fuel charging wiring.
- fuel injection supply manifold (9F792).
- fuel pressure regulator (9C968).
- fuel pressure relief valve (9H321).
- A/C compressor clutch relay.
- fuel pump relay.

The fuel charging and controls system is:

- a multiport, sequential fuel injection (SFI) system.
- pulse-width modulated.
- mass air flow controlled.

## Component Locations

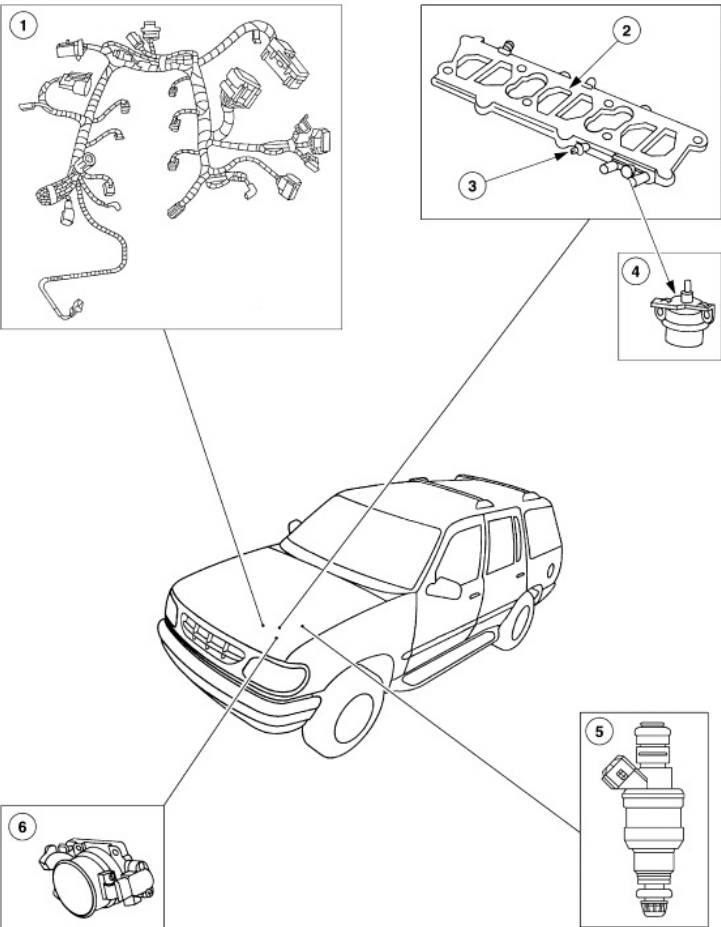

GV0743-A

Item	Part Number	Description
1	—	Fuel Charging Wiring
2	9F792	Fuel Injection Supply Manifold
3	9H321	Fuel Pressure Relief Valve
4	9C968	Fuel Pressure Regulator
5	9F593	Fuel Injectors
6	9E926	Throttle Body

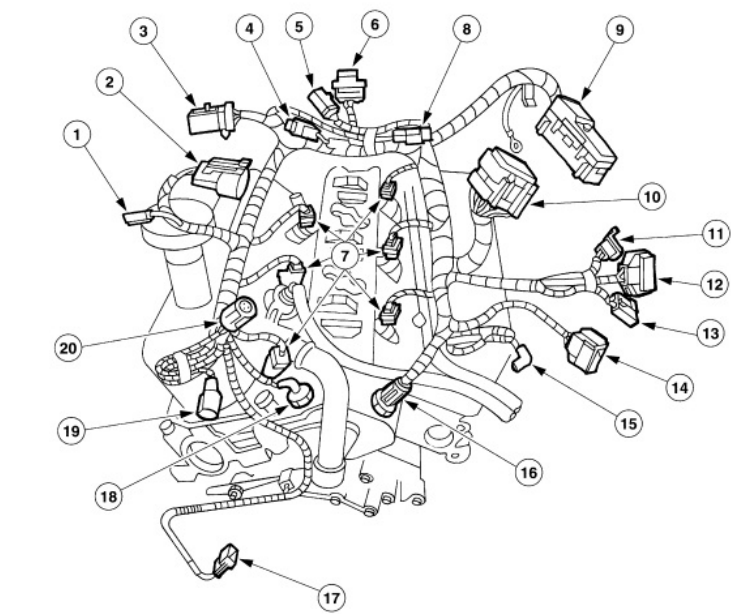

GV0573-A

Item	Part Number	Description
1	—	Radio Ignition Interference Capacitor Electrical Connector (Part of 14401)
2	—	Ignition Coil Electrical Connector (Part of 14401)
3	—	LH Transmission Harness Electrical Connector (Part of 14401)
4	—	RH Heated Oxygen Sensor (HO2S) Electrical Connector (Part of 14401)
5	—	RH Transmission Harness Electrical Connector (Part of 14401)
6	—	Camshaft Position Sensor (CMP) Electrical Connector (Part of 14401)
7	—	Fuel Injector Electrical Connectors (Part of 14401)
8	—	LH Heated Oxygen Sensor (HO2S) Electrical Connector (Part of 14401)
9	—	Powertrain Control Module Electrical Connector (Part of 14401)
10	—	Engine Bulkhead Electrical Connector (Part of 14401)
11	—	Idle Air Control (IAC) Electrical Connector (Part of 14401)
12	—	EGR Pressure Transducer Electrical Connector (Part of 14401)
13	—	EGR Vacuum Regulator (EVR) Electrical Connector (Part of 14401)
14	—	Throttle Position (TP) Sensor Electrical Connector (Part of 14401)
15	—	Oil Pressure Sending Unit Electrical Connector (Part of 14401)
16	—	Engine Coolant Temperature (ECT) Sensor Electrical Connector (Part of 14401)
17	—	Crankshaft Position (CKP) Sensor Electrical Connector (Part of 14401)
18	—	Water Temperature Indicator Sender Unit Electrical Connector (Part of 14401)
19	—	Manifold Absolute Pressure (MAP) Sensor Electrical Connector (Part of 14401)
20	—	Intake Air Temperature (IAT) Sensor Electrical Connector (Part of 14401)

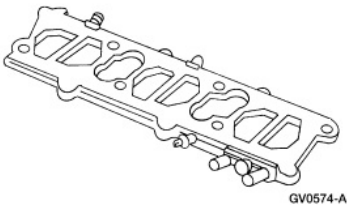

GV0574-A

The fuel injection supply manifold:

- delivers fuel to the individual fuel injectors.
- receives fuel from the fuel supply line.
- returns unused fuel to the fuel tank (9002) through the fuel return line.

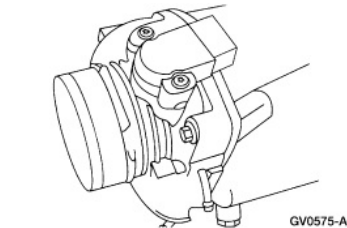

GV0575-A

The throttle body:

- controls air supply to the upper intake manifold (9424) by positioning the throttle plate.
- connects the accelerator cable (9A758) and, if equipped, the speed control actuator cable (9A825) to the throttle plate.

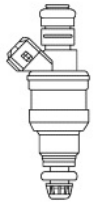

GV0744-A

The fuel injectors (9F593):

- are electrically operated by the powertrain control module (PCM) (12A650).
- atomize the fuel as the fuel is delivered.
- are deposit resistant and self cleaning.
- each has an internal solenoid which opens a needle valve to inject fuel into the lower intake manifold.



GV0097-A

The fuel pressure relief valve is used to inspect and relieve fuel pressure.

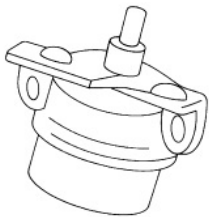

GV0576-A

The fuel pressure regulator:

- maintains a constant fuel pressure throughout the fuel system and to the fuel injectors.
- is spring-loaded and operated by intake manifold vacuum.

The fuel pump relay engages the fuel pump when energized by the powertrain control module.

---