

FORD C3 (3 Speed) A4LD (4 Speed)

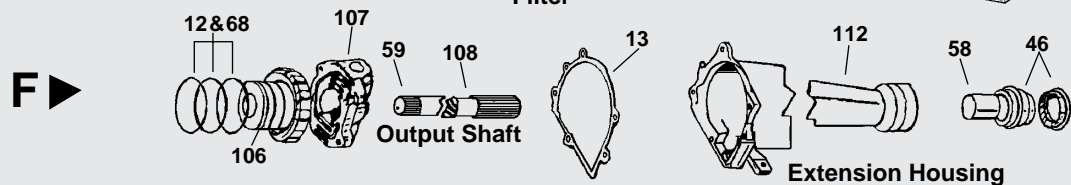

FORD C3 (3 Speed) A4LD (4 Speed)

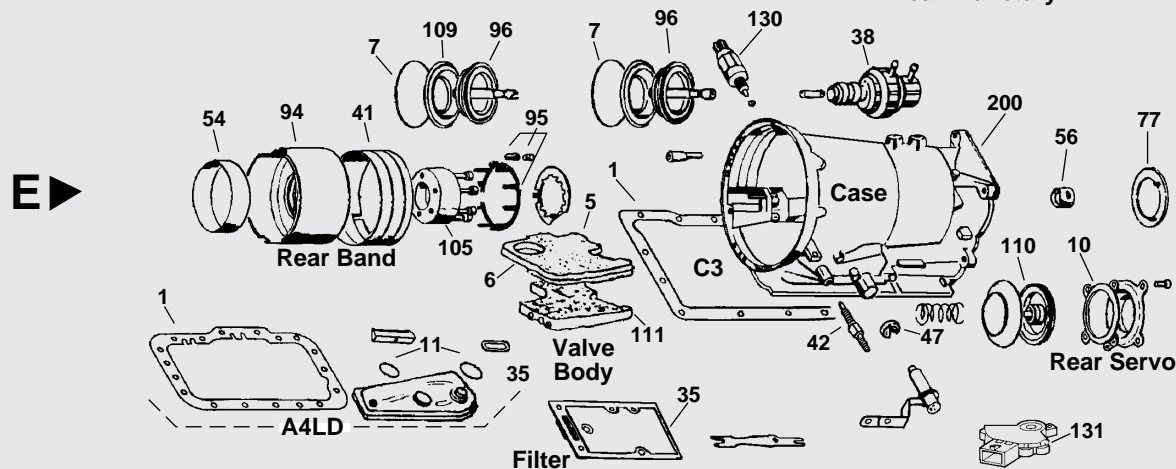
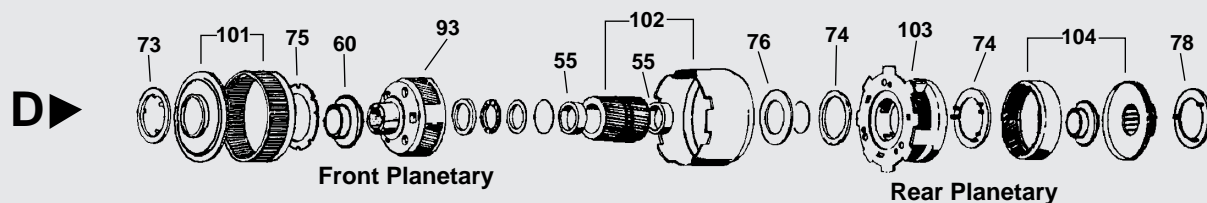
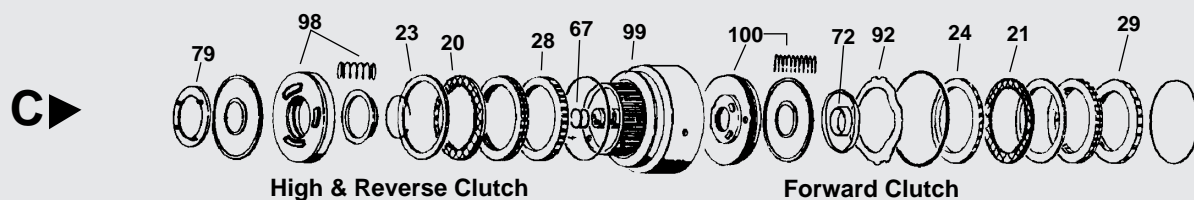
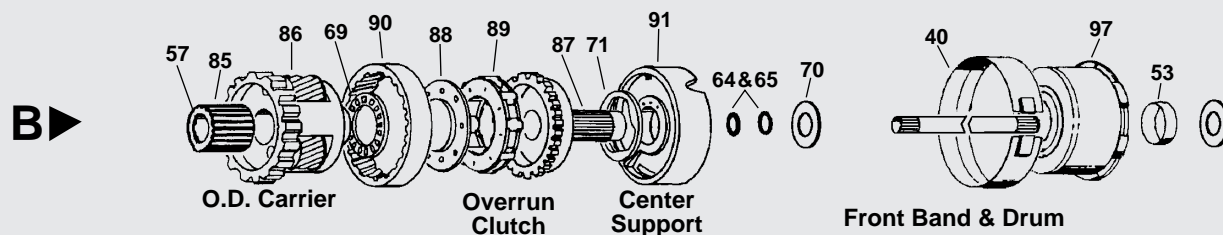
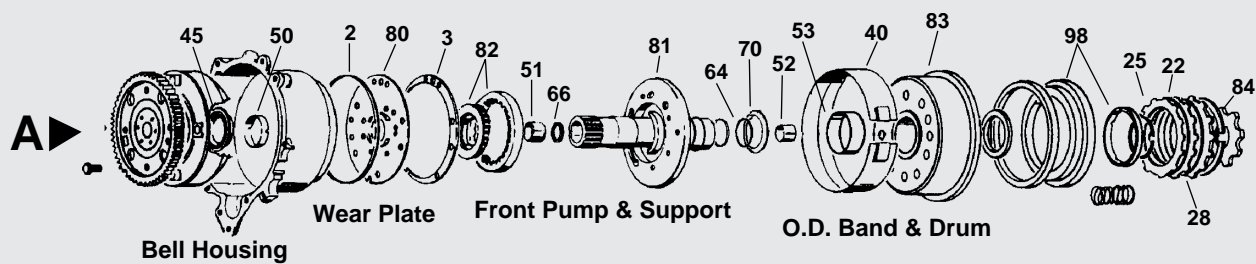
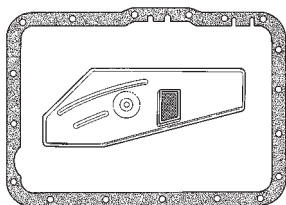

**18 Bolt Pan - 4WD
Screen - A4LD
FK27800D - Early 85
FK27800F - Late 85-95**

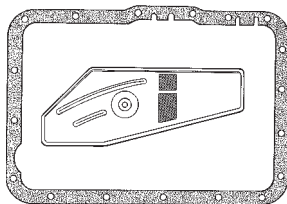

**18 Bolt Pan - 2WD
Screen - A4LD
FK27800E - Early 85
FK27800G - Late 85-95**

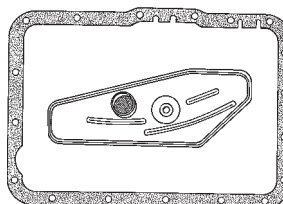

**18 Bolt Pan - 2WD
Screen with 3/8" Neck
A4LD - 89-95
FK27800H**

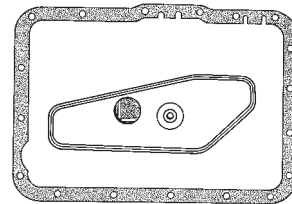

**18 Bolt Pan - 2WD
Dacron - No Neck
A4LD - 85-88
FK27800K**

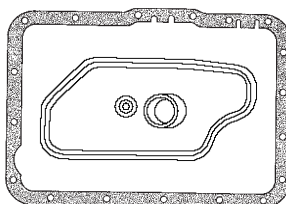

**18 Bolt Pan - 4WD
Dacron with 1-1/2" Neck
A4LD - 85-95
FK27800M**

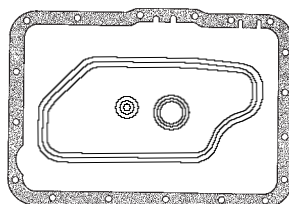

**18 Bolt Pan - 2WD
Dacron - No Neck
A4LD - 89-95
FK27800N**

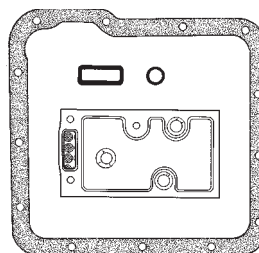

**13 Bolt Pan
C3 74-87
FK27800**

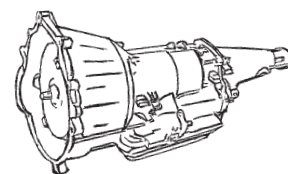

**Rear Wheel Drive
C3**

REBUILDER KITS

DESCRIPTION	QTY.	YEAR	DELUXE KIT	MASTER O/H KIT	LESS STEELS KIT	OVERHAUL KIT	GASKET & SEAL KIT
To order Kits with all Borg Warner frictions, use a 'KB' prefix instead of the traditional 'K' prefix.							
Rebuilder Kits - C3	1	74-77	K2700-R	K2700	K2700-LS	K27900B	K27900B-1
Rebuilder Kits - C3	1	78-87	K2700A-R	K2700A	K2700-LS	K27900B	K27900B-1
Rebuilder Kits -A4LD- w/Thick Frictions (1)	1	85-89	K2700D-R	K2700D	K2700D-LS	K27900F	K27900F-1
Rebuilder Kits -A4LD - w/Thin Frictions	1	90-95	K2700F-R	K2700F	K2700F-LS	K27900F	K27900F-1

(1) Deluxe Kit contains 27800G, 2WD filter. If 4WD filter is desired, order part no. 27800M. If 2WD, 1989-Up filter is used, order 27800N.

ILL.	DESCRIPTION	QTY.	YEAR	PART NO.	REFERENCE NO.
------	-------------	------	------	----------	---------------

VALVE BODY KITS

N.I.	TRANSO®				
N.I.	Shift Kit® - Corrects 1-2 Shift, Passing Gear Problems - C3	1	74-87	K27908	SK®-C3
N.I.	Junior Shift Kit® - Corrects High Clutch Failure, No 4th - A4LD	1	85-95	K27908J	SK®A4LD
	SUPERIOR				
N.I.	Shift Correction Package - Includes Steel Modulator Valve - A4LD.....	1	85-95	27C01	K4ALD

MISCELLANEOUS GASKETS & SEALS/PAN GASKETS

1E	Gasket - Oil Pan:				
	- Cork & Neoprene - C3.....	1	74-87	13700X	D5ZZ-7A191B
	- Fibre - C3	1	74-87	13700F	D5ZZ-7A191B
	- Korcork - C3	1	74-87	13700S	D5ZZ-7A191B
	- Cork & Neoprene - A4LD.....	1	85-95	13720X	E5TZ-7A191A
	- Fibre - A4LD	1	85-95	13720F	E5TZ-7A191A
	- Korcork - A4LD.....	1	85-95	13720S	E5TZ-7A191A

C3/A4LD

FORD C3 (3 Speed) A4LD (4 Speed)

ILL.	DESCRIPTION	QTY.	YEAR	PART NO.	REFERENCE NO.
MISCELLANEOUS GASKETS & SEALS/PAN GASKETS					
2A	Seal - Front Pump - Lathe Cut - All	1	74-95	13701	D5ZZ-7A248A
3A	Gasket - Front Pump to Case - All	1	74-95	13702	F5TZ-7A136A
4B	Seal - Center Support - Lathe Cut:				
	- Narrow - Viton - .080 Wide - A4LD	2	85-92	13779	E5TZ-7D429A
	- Wide - Viton - .100 Wide - A4LD	2	93-95	13779A	F3TZ-7D429A
5E	Gasket - Valve Body - Upper:				
	- C3	1	74-87	13704	D4ZZ-7D100B
	- A4LD	1	85-95	13777	E8RY-7C155A
	- .015 Thick - A4LD	1	85-95	13777T	E8RY-7C155A
6E	Gasket - Valve Body - Lower:				
	- C3	1	74-87	13705	D4ZZ-7D100A
	- A4LD	1	85-95	13776	E8RY-7D100A
	- .015 Thick - A4LD	1	85-95	13776T	E8RY-7D100A
7E	Overdrive/Intermediate Servo Cover - O-Ring - From Late 85 - All	1	86-95	13706A	E6TZ-7D040A
10E	Gasket - Rear Servo Cover - w/Metal Core - All	1	74-95	13708	D4ZZ-7L173A
11E	Gasket - Rubber Seal - Oil Filter - C3	1	74-87	13703	D4ZZ-7E062A
11E	O-Ring - Oil Filter:				
	- Large - .827 x .078 - Early 85 - A4LD	1	85	13782	E5TZ-7A469A
	- Large - .827 x .118 - Late 85 - A4LD	1	85-95	13783A	E6TZ-7A469A
	- Small - .590 x .078 - Early 85 - A4LD	1	85	13783	E5TZ-7A469B
	- Small - .590 x .118 - Late 85 - A4LD	1	85-95	13782A	E6TZ-7A469B
13F	Gasket - Extension Housing - All	1	74-95	13709	D4ZZ-7086B
N.I.	Washer - Front Pump Bolt - Rubber Coated - All	8	74-95	13718	E830124S
N.I.	Quad-Ring - Throttle Shaft - All	1	74-95	3499AL	386078-S
N.I.	O-Ring - Filler Tube - All	1	74-Up	3291L	87034-S94
N.I.	O-Ring - Speedometer to Case - All	1	74-95	3410L	87036-S94
N.I.	Check Balls - Valve Body - Viton - All	5	74-95	13924	E0AZ-7E195A
N.I.	Check Valve - Servo - Accumulator - (Hockey Puck)	1	85-95	13749	E0TZ-7D376A
N.I.	Seal: Double Lip Rear Servo Piston - V Cut - Sm/Lg	1	74-95	K3435L	N.L.
CLUTCH PLATES					
Order Frictions with "B" prefix for Borg Warner brand, "R" prefix for Raybestos brand.					
20C	Friction - High - Reverse:				
	- .075 - 48 Teeth - All	4/6	74-89	27304	D4ZZ-7B164B
	- .068 - A4LD	5/6	90-95	27304A	F0TZ-7B442B
21C	Friction - Forward:				
	- .075 - All	3/6	74-89	27404	E3ZZ-7B164A
	- .068 - A4LD	5/6	90-95	27404A	F0TZ-7B164A
22A	Friction - Overdrive - Direct:				
	- .078 - A4LD	2/3	85-89	27504	E5TZ-7B164B
	- Wide Tooth - .068 - A4LD	3	90-95	27504A	F0TZ-7B164C
23C	Steel - High - Reverse:				
	- .082 - C3	4/6	74-87	27305	D4ZZ-7B442B
	- .071 - All	5/6	78-89	27305A	D8ZZ-7B442B
	- .065 - A4LD	5/6	90-95	27305B	F0TZ-7B442B
24C	Steel - Forward:				
	- .082 - C3	3/6	74-77	27505	D4ZZ-7B442A
	- .071 - All	5/6	78-89	27505A	D8ZZ-7B442A
	- .065 - A4LD	5/6	90-95	27505B	F0TZ-7B442A
25A	Steel - Overdrive - Direct:				
	- .071 - A4LD	2/3	85-89	27305A	D8ZZ-7B442B
	- .065 - A4LD	2/3	90-95	27305B	F0TZ-7B442B

FORD C3 (3 Speed) A4LD (4 Speed)

ILL.	DESCRIPTION	QTY.	YEAR	PART NO.	REFERENCE NO.
PRESSURE PLATES					
28A,C	High/Overdrive - .220 - All	1	74-89	27307A-R	D4ZZ-7B066B
28A,C	High/Overdrive - .200 - A4LD	1	90-95	27307C-R	F0TZ-7B066B
29C	Forward - .215 - All.....	1	74-89	27307-R	D4ZZ-7B066A
29C	Forward - .200 - A4LD	1	90-95	27307B-R	F0TZ-7B066A
FILTERS/FILTER KITS					
Order Filter Kits with "FK" prefix for Cork-Neoprene, "FFK" prefix for Fibre.					
N.I.	Filter Kit:				
	- C3	1	74-87	FK27800	D4ZZ7A098B
	- w/4WD - Deep Pan - Early 85 - Screen - A4LD	1	84-85	FK27800D	E5TZ-7A098A
	- w/4WD - Deep Pan - Late 85 - Screen - A4LD	1	85-95	FK27800F	E6TZ-7A098A
	- w/4WD - Dacron - 3rd Design - A4LD	1	85-95	FK27800M	F5TZ-7A098B
	- w/2WD - Early 85 - Screen - A4LD.....	1	84-85	FK27800E	E5TZ-7A098B
	- w/2WD - Late 85 - Screen - A4LD.....	1	85-88	FK27800G	E6TZ-7A098B
	- w/2WD - Dacron - A4LD	1	85-88	FK27800K	E6TZ-7A098B
	- w/2WD - Screen - A4LD	1	89-95	FK27800H	E9TZ-7A098C
	- w/2WD - Dacron - 3rd Design - A4LD	1	89-95	FK27800N	F5TZ-7A098A
35E	Filter - Screen:				
	- C3	1	74-87	27800	N.L.
	- w/4WD - Deep Pan - Early 85 - Square Inlet - A4LD.....	1	84-85	27800D	85GT7A098AC
	- w/4WD - Deep Pan - Late 85 - Square Inlet - A4LD.....	1	85-95	27800F	N.L.
	- w/2WD - Early 85 - A4LD	1	84-85	27800E	N.L.
	- w/2WD - Late 85 - A4LD.....	1	85-88	27800G	84GT7A098AD
	- w/2WD - Round Hole - Short Lip - A4LD	1	89-95	27800H	87GT7A098AA
35E	Filter - Dacron:				
	- w/2WD - Late 85 - A4LD.....	1	85-88	27800K	85GT7A098AD
	- w/2WD - 3rd Design - A4LD	1	89-95	27800N	XL2Z-7A098CA
	- w/4WD - Late 85 - 3rd Design - A4LD.....	1	85-95	27800M	XL2Z-7A098DA
VACUUM MODULATORS					
38E	Adjustable Type - w/Dual Area Diaphragm - 2 Pipe - C3	1	74-76	27830	D4ZZ-7A377B
38E	Adjustable Type - w/Single Area Diaphragm:				
	- C3	1	74-80	27830A	D6ZZ-7A377A
	- White Stripe - 6 Cyl. - C3	1	80-87	27830B	E0BZ-7A377A
	- Green Stripe - 6 Cyl. - C3.....	1	80-87	27830C	E1SZ-7A377B
	- Black Stripe - 4 Cyl. - C3.....	1	81-87	27830D	E1ZZ-7A377B
	- Brown Stripe - A4LD	1	85-95	27830G	E5TZ-7A377C
	- Silver & Gray-Turbo Only - A4LD, C3	1	85-95	27830J	E4SZ-7A377A
38E	Modojuster Modulator - All (4)	1	85-95	M27830G	N.L.
	(4) The modojuster features an external adjustment mechanism.				
BRAKE BANDS					
Order NEW Brake Bands with "B" prefix for Borg Warner brand, "R" prefix for Raybestos brand.					
40A,B	Intermediate Front & Overdrive - Flex:				
	- All	2	74-95	27320H	D8ZZ-7D034A
	- All - Relined	2	74-95	27320H-RL	D8ZZ-7D034A
	- C3 - Relined.....	1	74-87	27320F-RL	E6TZ-7D034A
40A	Overdrive - Split Style - 4.0L A4LD	1	90-91	27320J	F0TZ-7F196A
41E	Reverse:				
	- All	1	74-95	27520A	E3ZZ-7D095A
	- All - Relined	1	74-95	27520A-RL	E3ZZ-7D095A
42E	Nut - Band Adjusting - Intermediate & Overdrive - All	1/2	74-95	26610	380850S

C3/A4LD

FORD C3 (3 Speed) A4LD (4 Speed)

ILL.	DESCRIPTION	QTY.	YEAR	PART NO.	REFERENCE NO.
METAL CLAD SEALS					
45A	Front Pump - Bell Housing: - Shallow Lip - C3	1	74-87	27601A	D4ZZ-7A248A
	- Deep Lip - All	1	85-95	27601B	E5TZ-7A248A
46F	Extension Housing: - w/o Boot - All	1	74-95	27695	D5ZZ-7052A
	- w/Boot - All	1	74-95	27695E	D5ZZ-7052A
47E	Manual Control Lever Seal - All	1	74-95	6507A	D5ZZ-7B498A
BUSHINGS					
N.I.	Bushing Kit - Complete: - C3	1	74-87	K27905	N.L.
	- A4LD	1	85-89	K27905D	N.L.
	- A4LD	1	90-95	K27905E	N.L.
50A	Bell Housing: - Bronze - All	1	74-95	27001A	N.L.
	- Babbitt - All	1	74-95	27001B	N.L.
51A	Front Pump Stator Support: - Steel - Backed - Front - All	1	74-89	27000	N.L.
51A	- Notched Bronze - Front - A4LD	1	90-95	27000B	N.L.
52A	- Rear - All	1	74-95	27000A	N.L.
53B	High Drum - Cast Iron - All (90-95 A4LD)	1	74-95	27002	N.L.
53A,B	High Drum/Overdrive Drum - Steel - A4LD	2	85-95	27002A	N.L.
54E	Reverse Drum - All	1	74-95	27004	N.L.
55D	Sun Gear - All (Omitted 4.0L)	2	74-95	27003	N.L.
56E	Case: - All	1	74-95	27005	N.L.
57B	Overdrive Sun Gear - A4LD	1	85-95	27000	N.L.
58F	Extension Housing - All	1	74-95	16001A	D7FZ-7A034A
59F	Output Shaft Bushing - Bronze - A4LD	1	85-91	27006	N.L.
59F	Output Shaft Bearing - A4LD	1	92-95	27976	N.L.
60D	Front Planet Washer/Bushing: - Early Steel Planets - A4LD (7)	1	86-90	27007	E7TZ-7A045A
	- Late Steel Planets - Top Hat - Bronze - A4LD	1	91-95	27007A	F0TZ-7D090A
N.I.	Center Support/Intermediate Shaft - A4LD	1	85-95	27010	N.L.
(7) On models with 4.0L engines, a bearing and race package are used. See washer section, part no. K27211B.					
SEALING RINGS/RING KITS					
Order Sealing Rings with "T" suffix for Teflon.					
N.I.	Ring Kit: - Complete - C3	1	74-87	K27901	N.L.
	- Complete - Part Metal, Teflon, & Viton - A4LD	1	85-95	K27901E	N.L.
	- Metal/Teflon - w/o Viton - A4LD	1	85-95	K27901S	N.L.
64A/B	Hi Drum/Overdrive Drum - Metal - All	2	74-95	27228	D4ZZ-7D025A
64A	Overdrive Drum - Teflon - A4LD	2	85-95	27229T	E5TZ-7D025A
66A	Front Pump Support - Teflon - A4LD	1	85-95	27230	E5TZ-7L323A
67C	Forward Clutch Drum - All	2	74-95	27227	D4ZZ-7D019A
68F	Governor Housing: - C3	3	74-87	27645	D4ZZ-7D011B
	- Plated Gray - Can Retro-fit to 1974 - All (9)	3	74-95	27645A	90GT-7D011A
(9) Viton seals also available. Order part no. 13675.					
THRUST WASHERS/NEEDLE BEARINGS					
N.I.	Washer Kit - Complete: - Includes 27209D - C3	1	74-87	K27907	N.L.
	- No Bearings Or Selectives - A4LD	1	85-89	K27907E	N.L.
	- No Bearings Or Selectives - A4LD	1	90-95	K27907F	N.L.

FORD C3 (3 Speed) A4LD (4 Speed)

ILL.	DESCRIPTION	QTY.	YEAR	PART NO.	REFERENCE NO.
THRUST WASHERS/NEEDLE BEARING (Cont.)					
70A/B	Front Pump/Center Support - Selectives - Plastic - Small I.D. (10) :				
	- .047 - All	AR	74-95	27209A	F0TZ-7D014M
	- .063 - All	AR	74-95	27209B	F0TZ-7D014B
	- .079 - All	AR	74-95	27209C	F0TZ-7D014F
	- .094 - All	AR	74-95	27209D	F0TZ-7D014J
	- .110 - All	AR	74-95	27209E	F0TZ-7D014L
70A/B	Front Pump/Center Support - Selectives - Metal - Small I.D. (10) :				
	- .055 - All	AR	74-95	27209J	F0TZ-7D014A
	- .063 - All	AR	74-95	27209K	F0TZ-7D014B
	- .067 - All	AR	74-95	27209L	F0TZ-7D014C
	- .071 - All	AR	74-95	27209M	F0TZ-7D014D
	- .074 - All	AR	74-95	27209S	F0TZ-7D014E
	- .079 - All	AR	74-95	27209N	F0TZ-7D014F
	- .082 - All	AR	74-95	27209T	F0TZ-7D014G
	- .087 - All	AR	74-95	27209P	F0TZ-7D014H
	- .094 - All	AR	74-95	27209R	F0TZ-7D014J
	- .102 - All	AR	74-95	27209U	F0TZ-7D014K
	- .110 - All	AR	74-95	27209V	F0TZ-7D014L
71B	Center Support - Thrust - 3" O.D. x 2 19/32" I.D. - A4LD	1	85-92	27217	E5TZ-7L326A
60D	Front Planet Thrust Washer/Bushing - For Steel Planet - A4LD	1	86-90	27007	E7TZ-7A045A
60D	Front Planet Thrust Washer/Bushing - For Steel Planet - A4LD	1	91-95	27007A	F0TZ-7D090A
72C	Forward Cylinder Hub - Thrust - 3 Tabs - w/Aluminum Planet - All	1	74-89	27211A	D4ZZ-7D090A
73D	Forward Ring Gear Hub - Thrust - 4 Tabs - w/Aluminum Planet - All	1	74-89	27211	D4ZZ-7D090B
74D	Reverse Planet - Thrust - Front & Rear - w/Aluminum Planet - All	2	74-87	27213	D4ZZ-7A166A
74D	Reverse Planet Washer:				
	- Front - w/Steel Planet - A4LD	1	85-95	27213A	F0TZ-7A166A
	- Rear - w/Steel Planet - A4LD	1	85-95	27213B	F0TZ-7A166B
75D	Forward Planet Thrust - C3	1	74-87	27213	D4ZZ-7A166A
76D	Input Shell - Thrust - 27 Teeth - All	1	74-95	27215	D4ZZ-7D066A
77E	Output Shaft Park Gear/Case: - Large O.D. - All	1	74-95	27216	D4ZZ-7B368A
78D	Output Shaft Hub/Case:				
	- All exc. 4.0L Engine	1	74-95	27218	D4ZZ-7D422A
	- Large I.D. - A4LD - 4.0L Engine	1	90-95	27218A	F0TZ-7D422A
79C	Intermediate Brake Drum:				
	- Cast Iron Drum - C3, A4LD	1	74-95	27210	D4ZZ-7C096A
	- Stamped Steel Drum - A4LD	1	85-89	27210D	E5TZ-7C096A
N.I.	Reverse Drum/Case Thrust (under Sprag Race) - 4.0L	1	90-95	27224	N.L.
N.I.	Reverse Drum/Case Thrust w/guides (under Sprag Race) -4.0L	1	90-Up	K27224	N.L.
N.I.	Washer Kits (Use w/SPS112A, See Index):				
	- Front/Rear Planet Assembly	1	-	QWK2020	N.L.
	- Large Pinion Overdrive Planet Assembly	1	-	QWK2031	N.L.
	- Small Pinion Overdrive Planet Assembly	1	-	QWK2032	N.L.
SHIMS					
N.I.	Front & Rear Aluminum Planet Qwik Shim Repair Kit				
	- .030 Top or Bottom - A4LD	AR	85-95	TS8030	N.L.
	- .015 Top or Bottom - A4LD	AR	85-95	TS8015	N.L.
BEARINGS					
N.I.	Bearing Kit - A4LD	1	85-95	K27907B	N.L.
N.I.	Forward Drum/Planet - 2nd Design - w/Steel Planet - A4LD	1	90-95	K27211B	F3TZ-7D234A
N.I.	Center Support Rear - Small - Snap Shell Design - (Forward Drum):				
	- 4.0L - 4.01mm - 1 I.D. Notch - A4LD	1	93-95	27219A	F3TZ-7C096A
	- 4.0L - 3.81mm - 2 I.D. Notches - A4LD	1	93-95	27219B	F3TZ-7C096B
	- 4.0L - 3.62mm - 3 I.D. Notches - A4LD	1	93-95	27219C	F3TZ-7C096C
	- 4.0L - 3.41mm - 4 I.D. Notches - A4LD	1	93-95	27219D	F3TZ-7C096D
(10) Plastic/Metal washers can be used on pumps, 74-95; and center supports, 85-94.					

C3/A4LD

FORD C3 (3 Speed) A4LD (4 Speed)

ILL.	DESCRIPTION	QTY.	YEAR	PART NO.	REFERENCE NO.	
THRUST WASHERS/NEEDLE BEARINGS (Cont.)						
	BEARINGS (CONT.)					
69B	Overdrive Inner Race - A4LD	1	85-95	27222	E5TZ-7L495A	
71B	Center Support - Front - .107 - A4LD.....	1	93-95	27217B	F3TZ-7L326A	
75D	Forward Planet:					
	- (Ring Gear Hub w/I.D. Lip) - A4LD	1	85-88	57407	F1TZ-7F374A	
	- (Ring Gear Hub w/o I.D. Lip) - A4LD	1	88-95	27407	F2TZ-7F374AA	
HARD PARTS						
Hard Parts may only require the base number for OEM/Aftermarket New. A "N" suffix may also be required or a "-R" suffix for remanufactured. Exceptions are listed individually.						
NOTE: A separate column is provided to indicate a primary or specific brand/type.						
ILL.	DESCRIPTION	BRAND	QTY.	YEAR	PART NO.	REFERENCE NO.
80A	Front Pump Wear Plate:- w/Align Plugs - All.....		1	74-95	27202U	E5TZ-7B472B
81A	Front Pump Assembly:					
	- C3	R	1	74-87	27200	D6ZZ-7A103A
	- w/6mm Bolts - A4LD		1	85-87	27200D	E5TZ-7A103A
	- w/8mm Bolts - A4LD		1	88-95	27200E	YL2Z-7A103JA
82A	Front Pump Gear Set - w/ Drive Gear O-Ring - 24T - All		1	74-95	K27201	N.L.
	Front Pump Gear Set - w/ Drive Gear O-Ring - 16T - All		1	74-95	K27201B	N.L.
83A	Overdrive Direct Drum:					
	- A4LD		1	85-89	27965	E9TZ-7L669A
	- A4LD.....		1	90-95	27965A	F0TZ-7L669A
84A	Overdrive Sun Gear Drive Plate - A4LD		1	85-95	27964	E5TZ-7660A
85B	Overdrive Sun Gear - A4LD.....		1	85-95	27966	F7RZ-7D063AA
86B	Overdrive Planet:Assembly - A4LD		1	85-95	27413D	F7TZ-7B446AA
87B	Overdrive Outer Race Shaft:					
	- w/Ring Gear - Bushing Type - A4LD	R	1	85-91	27970	E5TZ-7A658A
	- w/Retainer - w/Ring Gear - Bearing Type - A4LD	R	1	92	27970A	N.L.
	- w/o Retainer -(w/Ring Gear for Reman Only)		1	93-95	27970B	F2TZ-7A658B
88B	Overdrive Overrunning Retainer Plate - 4-5/64" - A4LD		1	85-92	27221	E5TZ-7L339A
89B	Sprag: Overdrive Clutch:Metal -		1	85-92	27960A	E5TZ-7A089A
89B	Sprag: Overdrive Clutch:Plastic - Use w/T-5015		1	93-95	27960B	N.L.
90B	Overdrive Planet Ring Gear	R	1	85-92	27967	E5TZ-7A153A
90B	Overdrive Planet Ring Gear		1	93-95	27967B	F3TZ-7A153A
91B	Center Support: Narrow Viton Rings - A4LD	R	1	85-92	27902D	E5TZ-7A130A
	Center Support: Wide Viton Rings - A4LD.....		1	93-95	27902E	F1TZ-7A130AA
	Center Support: Wide Viton Rings - (11)		1	85-95	27902F	F5TZ-7A130B
	Center Support:Universal w/Bearing - A4LD.....		1	85-95	K27902T	F1TZ-7A130AA
92C	Forward Piston Rubber Cushion: All.....		1	77-89	27575	D8ZZ-7B070A
92C	Forward Piston Rubber Cushion: A4LD		1	90-95	27575A	F0TZ-7B070A
93D	Front Planet: - Aluminum - A4LD	R	1	85	27412	D4ZZ-7A398A
	Front Planet: - Steel - 27007 Bushing Type - A4LD.....	R	1	86-89	27412A	E8TZ-7A398A
	Front Planet - 6 Pinion - A4LD		1	90-95	27412B	F87Z-7A398AA
93D	Front Planet Assembly - 6 Pinion Update Pkg - A4LD.....		1	85-95	K27412A	F0TZ-7A398E
94E	Reverse Drum: Roller Clutch Type - All	R	1	74-96	27945R	D4ZZ-7C498A
	Reverse Drum: Sprag Type - A4LD	R	1	90-96	27945S	F0TZ-7C498A
	Reverse Drum - w/Sprag:- 4.0L - 26 Elements - A4LD.....		1	90-96	K27945	F0TZ-7C498A
95E	Sprag: - Low - 26 Elements - 4.0L - A4LD		1	90-95	27940	N.L.
95E	Roller: Spring & Retainer Kit (w/10 springs) - All.....		1	74-96	K27960	D4ZZ-7D191A
(11) 27902F center support requires bearings front & rear and must be purchased separately. Check bearing section for size.						

FORD C3 (3 Speed) A4LD (4 Speed)

ILL.	DESCRIPTION	BRAND	QTY.	YEAR	PART NO.	REF NO.
HARD PARTS (Cont.)						
96E	Intermediate/Overdrive Servo Piston Assembly:					
	- 2.300 - Cover I.D. # ZC.....		1	90-95	27528J	F77Z-7D021ZA
	- 2.100 - Cover I.D. # AA/AB - All.....		1	74-95	27528	F77Z-7D021A2A
	- 1.945 - Cover I.D. # BB - All.....		1	74-95	27528B	F2ZZ-7D021A
	- 1.845 - Cover I.D. # CA/CB - All.....		1	74-95	27528D	E3ZZ-7D021A
	- 1.775 - Cover I.D. # DB - All.....		1	90-95	27528G	F77Z-7D021DA
	- 1.720 - Cover I.D. # EB - All.....		1	90-95	27528E	F0ZZ-7D021A
	- 1.650 - Cover I.D. # FB - All.....		1	90-95	27528F	F0TZ-7D021B
97B	Drum - Intermediate Brake:					
	- w/4 or 5 Friction - Small O.D. Piston - Cast or Steel - All (12)	R	1	85-89	27300G	E5TZ-7D044E
	- w/4 or 5 Friction - Large O.D. Piston - Cast Iron (12)	R	1	90-95	27300H	F0TZ-7D044B
	- w/6 Friction - 4.0L - Cast Iron (12)		1	90-95	27300J	F0TZ-7D044C
98A/C	Retainer, Piston(Small) & Spring Set - O.D./Intermediate - All.....	R	1	85-95	K27920	N.L.
98A/C	Retainer, Piston(Large) & Spring Set - Intermediate - A4LD.....	R	1	90-95	K27920A	N.L.
99C	Forward Drum: - w/5 Friction - Thick - w/6 Friction - Thin (12)	R	1	85-95	27400D	E5TZ-7A360A
99C	Forward Drum: - w/4 Friction - Thick - w/5 Friction - Thin (12)	R	1	85-95	27400E	E5TZ-7A360B
100C	Retainer, Piston & Spring Set - Tall - Forward Drum - A4LD.....		1	85-95	K27921	N.L.
100C	Retainer, Piston & Spring Set - Short - Forward Drum - A4LD.....		1	85-95	K27921A	N.L.
101D	Hub - Front Ring Gear - w/o I.D. Lip.....		1	88-95	27408A	F87Z-7B067AC
101D	Front Ring Gear - Gear Only.....		1	94-95	27409	D4ZZ-7D392A
101D	Front Ring Gear: (w/Hub - Small I.D. - Reman Only - 85-88).....	R	1	85-88	27409	N.L.
101D	Front Ring Gear: (w/Hub - Large I.D. - w/o I.D. Lip - Reman Only).....	R	1	88-95	27409A	N.L.
102D	Sun Shell - w/o Sun Gear:					
	- w/o Snap Type - All.....		1	85-95	27510A	F0TZ-7D064A
	- Snap Type - A4LD.....		1	93-95	27510B	F3TZ-7D064A
102D	Sun Gear - Forward w/Bushing - All (Omit Bushings - 4.0L).....		1	74-Up	27511	D4ZZ-7D063A
102D	Sun Shell - w/Sun Gear:					
	- w/o Snap Type - 1st Design.....	R	1	74-86	27510	N.L.
	- w/o Snap Type - 2nd Design.....	R	1	87-95	27510A	N.L.
	- Snap Type.....	R	1	93-95	27510B	N.L.
103D	Rear Planet:					
	- Aluminum - All.....	R	1	85-90	27950	D4ZZ-7D006A
	- Steel - 4 or 6 Gear - Wide Tooth - A4LD.....	R	1	87-95	27950A	E7SZ-7D006C
	- Steel - 6 Gear - Narrow Tooth - 4.0L - A4LD.....		1	90-95	27950B	F0TZ-7D006A
104D	Output Ring Gear w/Hub:					
	- For Aluminum Planet - w/Recess - A4LD.....	R	1	85-90	27437	D4ZZ-7D164A
	- For Steel Planet - w/o Recess - A4LD.....	R	1	87-95	27437A	N.L.
	- For Steel Planet - w/Oil Notches - 4.0L - A4LD.....	R	1	90-95	27437B	N.L.
104D	Hub Output - Except 4.0 L (Hub Only).....	R	1	74-Up	27427	N.L.
105E	Inner Race: Roller Type - Small O.D. - A4LD.....		1	85-95	27600R	N.L.
105E	Inner Race: Sprag Type - Large O.D. - A4LD.....		1	90-95	27600S	N.L.
	Inner Race w/Guides - Large O.D. - A4LD.....		1	90-Up	K27600S	N.L.
106F	Governor Support - A4LD: For Viton Rings.....	R	1	85-89	27616	D8ZZ-7D220A
106F	Governor Support - A4LD: For C.I. Rings.....	R	1	90-95	27616A	F0TZ-7D220A
107F	Governor - Various - A4LD.....		1	85-95	27615A	N.L.
108F	Output - A4LD:					
	- 6T - 2WD - w/Bushing.....	R	1	87-91	27655B	N.L.
	- 6T - 2WD - w/Bearing.....	R	1	92-95	27655D	N.L.
	- 7T - 2WD - 4.0L - w/Bearing (Solid).....	R	1	92-95	27655E	N.L.
	- 4WD - w/Bushing.....	R	1	87-91	27655C	N.L.
	- 4WD - 4.0L - w/Bearing (Solid).....	R	1	92-95	27655F	N.L.
109E	Servo Cover - All:					
	- 1.945.....		1	85-95	27529A	E6TZ-7D027C
	- 2.11.....		1	85-95	27529	E6TZ-7D027B
	- 2.3.....		1	85-95	27529J	F77Z-7A027ZC
	(12) Drum will accomodate maximum frictions listed.					

C3/A4LD

FORD C3 (3 Speed) A4LD (4 Speed)

ILL.	DESCRIPTION	BRAND	QTY.	YEAR	PART NO.	REF NO.
HARD PARTS (Cont.)						
110E	Rear Servo Piston - w/Rod - All: - 2 Grooves.....	R	1	85-95	27530L	D7ZZ-7D189A
	- No Grooves	R	1	85-95	27530M	D7ZZ-7D189B
	- 1 Groove	R	1	85-95	27530N	D7ZZ-7D189C
	VALVE BODY - PREMIUM QUALITY					
111E	- 2 Solenoids - 2nd Design 3-4 - A4LD		1	88-95	P27990A	N.L.
111E	- 1 Solenoid - A4LD	R	1	85-95	27990B	N.L.
111E	- 2 Solenoids - A4LD	R	1	88-95	27990C	N.L.
112F	Extension Housing - 2WD - A4LD	R	1	85-95	27991	N.L.
115D	Oil Dam Output Hub - 4.0L Plastic		1	90-95	27910	F0TZ-3B176A
200E	Case - A4LD:					
	- w/Small Fitting And Roller Clutch.....	R	1	84-95	CA4LD-1	N.L.
	- w/Large Fitting And Roller Clutch.....	R	1	87-95	CA4LD-2	N.L.
	- w/Large Fitting And Sprag - 4.0L.....	R	1	90-95	CA4LD-3	N.L.
205B	Shaft - Input - A4LD		1	85-95	27933N	N.L.
N.I.	Sleeve Case Repair - Reverse Servo Inner Seal		1	74-95	27877S	N.L.
N.I.	Clutch Drum Repair Plate (For Steel Hi/Rev/OD Drums) - A4LD		1	85-95	27968P	N.L.
N.I.	Retainer - Overdrive/High Piston - A4LD		1	85-95	27920	E5TZ-7A527BA
N.I.	Retainer - Forward Piston - A4LD		1	85-95	27921	D4ZZ-7A527A
N.I.	Spring - Overdrive/High Piston - A4LD		20	85-95	27920S	F1TZ-7A480B
N.I.	Spring - Forward Piston - A4LD		15	85-95	27921S	F1TZ-7A480A
N.I.	Extendo Pin - Intermediate/Overdrive Servo		1	74-95	27875	N.L.
	VALVE BODY COMPONENTS					
N.I.	Spring Kit:					
	- Converter Shift Valve - A4LD (Aids In TCC Release & Calibration)		1	85-95	K27975	N.L.
	- 4-3 Torque Dem/TV Boost - A4LD (Eliminates Sensitive 4-3 Downshift).....		1	85-95	K27975B	E5TZ-7E479A
N.I.	Spring Kit: Converter Shuttle Valve - A4LD (Aids In TCC Release)		1	85-95	K27975D	E5TZ-7L490A
N.I.	Valve - Manual - 2nd Design - A4LD		1	85-95	27972	E8TZ-7C389A
N.I.	Sleeve - Manual Valve - A4LD		1	85-95	27972S	N.L.
N.I.	Valve - Pressure Regulator - Oversized - (Use Reamer T-9148) - A4LD		1	85-95	K27973	N.L.
N.I.	Valve - Boost - w/Sleeve - Large - .388 dia. - A4LD (w/O-Rings)		1	85-95	K27971	N.L.
N.I.	Valve - Boost - w/Sleeve - Small - .323 dia - A4LD (w/O-Rings)		1	85-95	K27971B	N.L.
N.I.	Valve - Boost - w/Sleeve - Large - .388 dia - A4LD		1	85-95	K27971A	N.L.
N.I.	Valve - Boost - w/Sleeve - Small - .323 dia - A4LD		1	85-95	K27971C	N.L.
N.I.	Valve Modulator Oversize- (Use Reamer T-9133) - ALL.....		1	74-95	27884	N.L.
N.I.	Plugs - Valve End - A4LD		1	85-95	K27886	N.L.
ELECTRICAL PRODUCTS						
N.I.	Solenoid Assembly:					
	- TCC - A4LD		1	85-95	5A-255	E5TZ-7F037A
	- TCC - A4LD - Teckpak		1	85-95	5T-255	E5TZ-7F037A
	- TCC - A4LD - Rostra		1	85-95	5R-255	E5TZ-7F037A
	- 3-4 Shift - A4LD		1	88-95	5A-256	E8TZ-7M107A
	- 3-4 Shift - A4LD - Teckpak.....		1	88-95	5T-256	E8TZ-7M107A
	- 3-4 Shift - A4LD - Rostra		1	88-95	5R-256	E8TZ-7M107A
N.I.	Solenoid - Master Kit - Teckpak - A4LD		1	85-95	31T-A4LD	N.L.
N.I.	Solenoid - Master Pack - Rostra - A4LD		1	85-95	31R-255	N.L.
130E	Neutral Safety Switch:					
	- 4 Pin - Screw In - All.....		1	77-95	15A-264	D6RY-7A247B
	- 5 Pin - Screw In - A4LD		1	85-95	15A-266	E6TZ-7A247A
N.I.	Sensor - Rear Differential - All - Large Body		1	90-95	20A-300	N.L.

C3/A4LD

MISCELLANEOUS PRODUCTS									
-------------------------------	--	--	--	--	--	--	--	--	--

N.I.	Pilot Sleeve for Crankshaft - 6-Bolt - 4.0L Engines	1	85-Up	27500P	D4ZZ-6434A
------	---	---	-------	---------------	------------

NOTES									
--------------	--	--	--	--	--	--	--	--	--
